

# flexiguide

## Product Specification

**Sealing Shims - metal waveguide shims with integrated rubber gaskets on both sides. Used for connecting two flat flange faces together in a rectangular waveguide system to create a pressure tight/waterproof joint.**

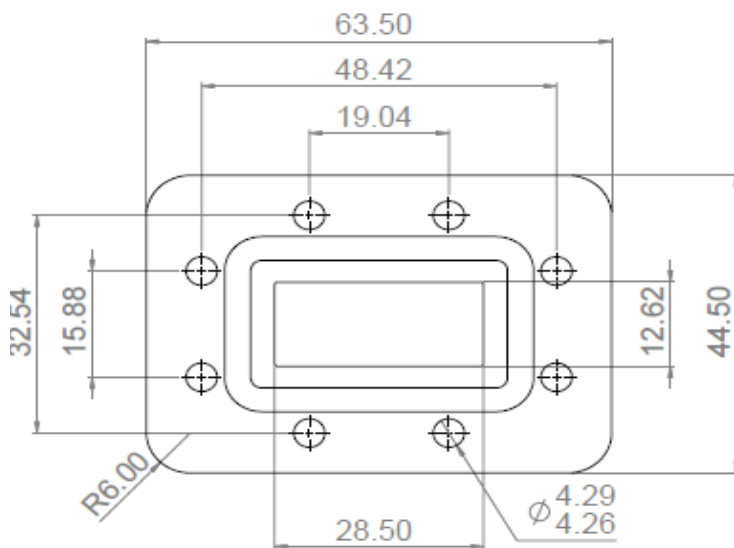

**Part Number:**

SS15C/H

**Description**

|                 |                               |
|-----------------|-------------------------------|
| Product Type:   | Sealing Shim                  |
| Waveguide Size: | WG15 / WR112 / R84            |
| Flange Face:    | 15C (CPR 112G) / 15H (PDR 84) |
| Material:       | Stainless Steel               |
| Thickness:      | 1.0 mm                        |
| Accessories:    | None                          |