

## Product Specification

**Waveguide Shims - with Flat Flange Faces for use in rectangular waveguide systems. Ideal for use sandwiched between two grooved flanges.**

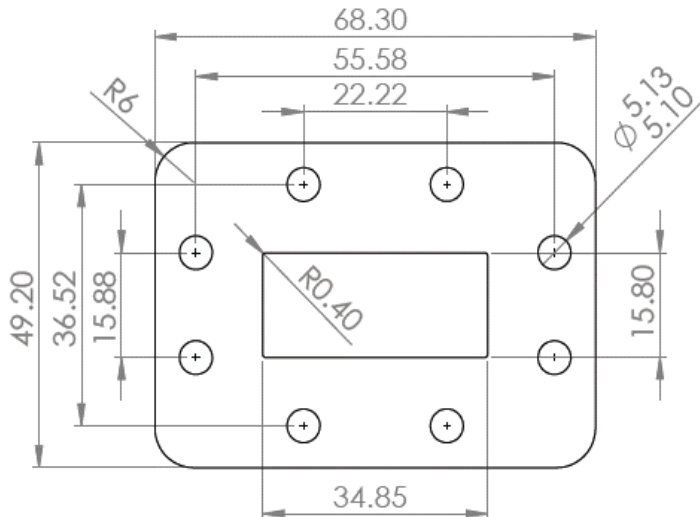

**Part Number:** WS14D/L

### Description

Product Type:	Plain Shim
Waveguide Size:	WG14 / WR137 / R70
Flange Face:	14D (CPR137F) / 14L (UDR70)
Material:	Stainless Steel
Thickness:	0.6 mm
Accessories:	None