

# flexiguide

## Product Specification

**Waveguide Shims - with Flat Flange Faces for use in rectangular waveguide systems. Ideal for use sandwiched between two grooved flanges.**

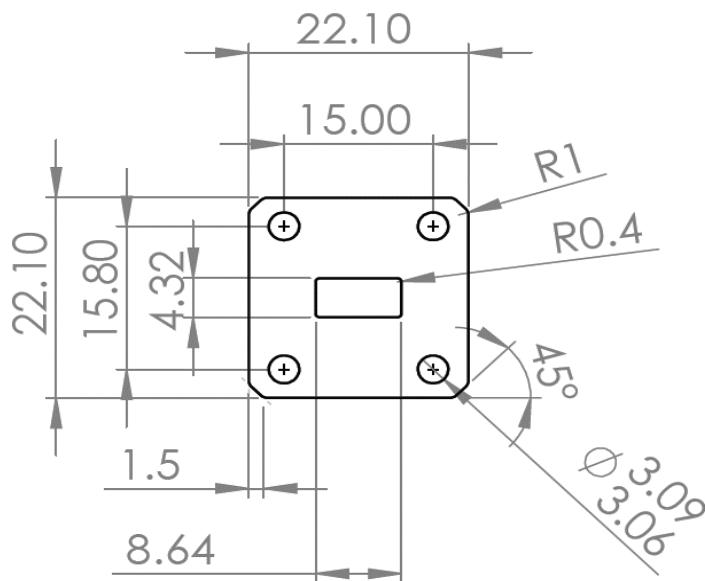
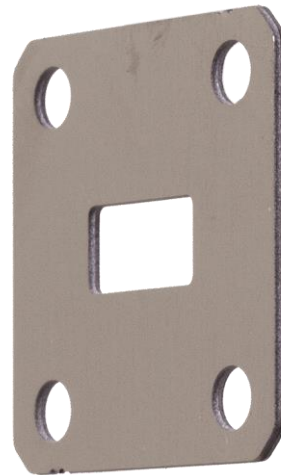

**Part Number:** WS21M

### Description

Product Type:	Plain Shim
Waveguide Size:	WG21 / WR34 / R260
Flange Face:	21M (UBR260)
Material:	Stainless Steel
Thickness:	0.6 mm
Accessories:	None