

# flexiguide

## Product Specification

**Waveguide Shims - with Flat Flange Faces for use in rectangular waveguide systems. Ideal for use sandwiched between two grooved flanges.**

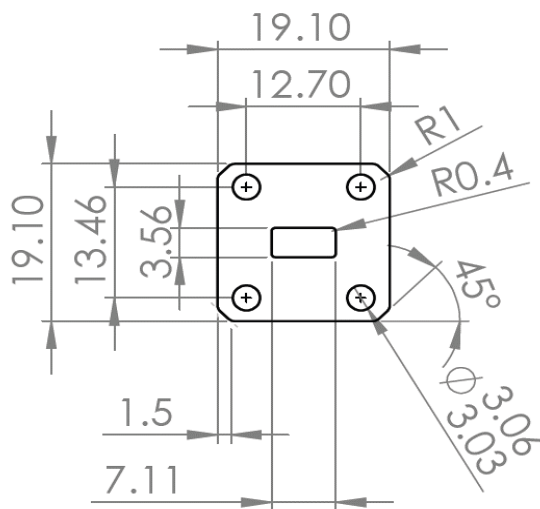

**Part Number:** WS22B/M

### Description

Product Type:	Plain Shim
Waveguide Size:	WG22 / WR28 / R320
Flange Face:	22B (UG599/U) / 22M (UBR320)
Material:	Stainless Steel
Thickness:	0.6 mm
Accessories:	None